

salzer

W I R E S F O R L I F E

ENTER

Press ALT + F4 to EXIT



Product Specifications

Size & Spool Types

Package Details

Sign Out

salzer Group
is India's leading
manufacturer of
low voltage switchgear
products with
international presence.

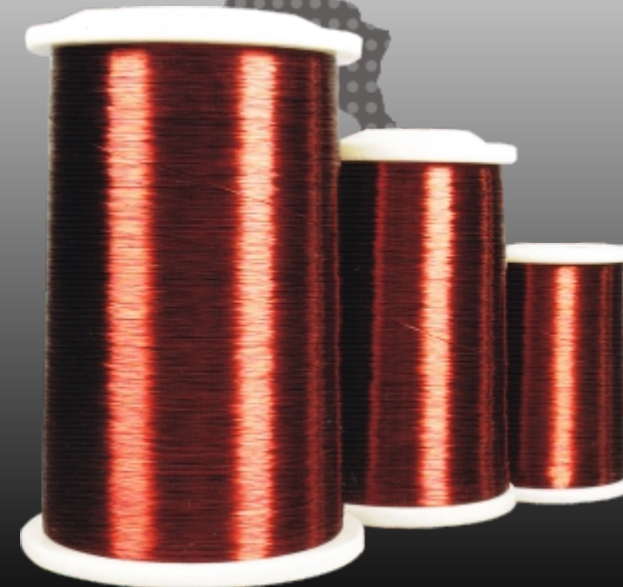

Profile

Product Specifications

Size & Spool Types

Package Details

Sign Out



www.salzergroup.com

Salzer has five world class manufacturing facilities with ISO 9001, ISO 4001 and ISO 18001 accreditation. The group has a diverse product portfolio ranging from cam switches, Load Break switches, wiring ducts, Toroidal transformers, Modular switches etc.

Salzer Magnet Wires (SMW), a part of salzer group, has a great vision and power of innovation in the field of enameled wires.

SMW draws its strength and quality from the state of the art manufacturing facilities. The enameling machines are fitted with on-line High Voltage continuity tester for detecting pin holes and weak spot on every millimeter. Also the latest PC based equipment for measurement of Dielectric Dissipation Factor (Tan d), ensures consistent wire quality during production.

SMW offers extensive range of enameled wires suitable for any known application in Transformers, Motors, Alternators, Contactors , Relays and Auto electrical. Our wires are also suitable for use in high speed coil winding machines.

Our enameled wires are manufactures to National and International Standards such as IS, NEMA, IEC, UL and JIS. The copper conductors are manufactured from 99.997% pure ETP grade copper and insulated with high temperature engineered enamel, which provides excellent dielectric properties and excellent resistance to stress cracking.

Salzer Group

Having been around the world and serving premier institutions for over 20 years, it was my ambition to bring a world class products to India and thus came Salzer in 1985.

We have tremendous support from our Customers, Shareholders, Financial Institutions, Employees and all other agencies, to continuously build the Organization from a humble beginning to a group of 5 Companies with International Affiliations.

We look forward to the same co-operation and confidence to optimize the business propositions in this liberalized and growing economy of India.

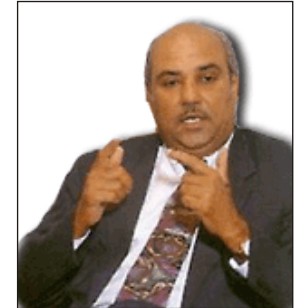

R. Doraiswamy
Managing Director

- Initiated in 1985, With a Successful track record of Success.
- 5 Factories with International Connection.
- International Product Approval Such as CSA, UL, VDE and CE.
- Worldwide availability of Salzer Products.
- A Full-fledged In-house Research and Development facilities Recognized by Government of India.
- ISO 9000 : 2000 Accreditation.
- Self-sufficient in house Captive Tool Room.

Product Specifications

Size & Spool Types

Package Details

Sign Out

Product Specifications

	1	2	3	4	5	6
Type of enameled wire	Self solderable	General Purpose	General Purpose	Self solderable	Self solderable	General Purpose
THERMAL CLASS	130(B)	130(B)	155(F)	155(F)	155(F)	155(F)
SPECIFICATION STANDARD	IS : 13730-4 IEC-60317-4 NEMA MW -75C JIS C 3202	IS : 13730-34 IEC-60317-34 JIS C 3202 - 1988	IS : 13730-3 IEC-60317-3 NEMA MW-5C	IS : 13730-19 IEC-60317-19 NEMA MW-28C	IS : 13730-20 IEC-60317-20 NEMA MW-79C	IS : 13730 IEC-60317 NEMA MW-24C
Chemical base of base coat	Polyurethane	Polyester	Modified Polyester	Polyurethane	Polyurethane	Polyester
Chemical base of top coat	Not applicable	Not applicable	Not applicable	Nylon	Not applicable	Polyamide
Range of wire (Diameter)	0.800-0.300 mm	3.000-0.300 mm	3.000-0.300 mm	1.000-0.300 mm	0.800-0.300 mm	1.60-0.300 mm
Insulation Range	Grade 1, 2 & 3 as per IEC and Single, Heavy & Triple as per NEMA					
Standard Colour	Standard Color - Reddish Brown, other colors as per requirement					
TECHNICAL PROPERTIES AS PER IS : 13730-0-1 IEC-603017-0-1						
Heat Shock	155	155	175	155	175	175
Cut Through (°C)	170	240	240	170	200	240
Solderable temperature (°C)	375	Not applicable	Not applicable	375	390	Not applicable
Resistance to Abrasion for 1.00mm dia grade 2 wire (n)	>9.3	>10.4	>10.4	>9.3	>8.1	>10.0
Resistance to refrigerants	Not applicable	Not applicable	Not applicable	Not applicable	Not applicable	Not applicable
Flexibility & Adherence	Good	Good	Good	Good	Good	Good
Bonding Temperature (°C)	Not applicable	Not applicable	Not applicable	Not applicable	Not applicable	Not applicable
SPECIAL CHARACTERISTICS	Self solderable property with good insulation resistance, high flexibility	Good thermal & electrical properties	Upgraded thermo mechanical properties compared to ordinary polyesters	Low coefficient of friction, besides properties of general purpose polyurethane	Self solderable property with its low dielectric dissipation factor under high freq.	Good mech., electrical & chemical resistance properties improved for high speed winding
APPLICATION	Relays, magnetic spools, universal & non impregnated winding for transformers.	General purpose rotating & static electrical equipments, oil transformers, control coils	Ignition Coils, oil filled transformers, relays contractors, fhp motors. Can be Upgraded	Small size motors, coils of electrical instruments, especially of high speed winding	Electrical instruments of machine tools, motors which have special requirements of this enamel	FHP motors, coils & relays audio & instrument coils.

Product Specifications

Size & Spool Types

Package Details

Sign Out



Product Specifications

	7	8	9	10	11
Type of enameled wire	General Purpose	High Temperature	High Temperature	Self solderable High Temperature	High Temperature
THERMAL CLASS	155(F)	180(H)	180(H)	180(H)	200(C)
SPECIFICATION STANDARD	IS : 13730-54 IEC-60317-54	IS : 13730-8 IEC-60317-8 NEMA MW-30C JIS C 3202 - 1988	IS : 13730-22 IEC-60317-22 NEMA MW-76C	IS : 13730-51 IEC-60317-51 NEMA MW-28C	IS : 13730-13 IEC-60317-13 NEMA MW-35C (Hermetic)
Chemical base of base coat	Polyester	Polyesterimide	Polyester /Polyesterimide	Polyurethane	Theicpolyester /Polyesterimide
Chemical base of top coat	Not applicable	Not applicable	Nylon	Not applicable	Polyanide-imide
Range of wire (Diameter)	3.000-0.300 mm	3.000-0.300 mm	3.000-0.300 mm	1.000-0.300 mm	3.000-0.300 mm
Insulation Range	Grade 1,2 & 3 as per IEC and Single, Heavy & Triple as per NEMA				
Standard Colour	Standard Color - Reddish Brown, other colors as per requirement				
TECHNICAL PROPERTIES AS PER IS : 13730-0-1 IEC-603017-0-1					
Heat Shock	175	200	200	200	220
Cut Through (°C)	240	300	265	240	320
Solderable temperature (°C)	Not applicable	Not applicable	Not applicable	450	Not applicable
Resistance to Abrasion for 1.00mm dia grade 2 wire (n)	>10.4	>10.9	>10.9	>7.8	>11.3
Resistance to refrigerants	Not applicable	Good	Not applicable	Not applicable	Very Good
Flexibility & Adherence	Good	Good	Good	Good	Very Good
Bonding Temperature (°C)	170/200	Not applicable	Not applicable	170/120	Not applicable
SPECIAL CHARACTERISTICS	General Purpose155°C Polyester with heat shock at higher mandrel diameter.	Good resistance against refrigerants, transformer oil. High burnout resistance.	Used in all 180°C class equipment requiring high speed winding , low coefficient of friction.	Good mech.,electrical & chemical resistance properties improved for Fast Solderability	Good resistance for refrigerants & chemical, burn-out resistant, windability low coefficient of friction
APPLICATION	General purpose rotating & static electrical equipments, oil transformers, control coils	FHP motors, hermetic application and thermal class 180°C equipments.	General purpose rotating & static electrical equipments	Fractional & integral horsepower motors, coils, relays instrument & audio coils	Hermetic motors, Armatures Alternators, Power Tools and high HP motors, suitable for high speed coil winding

Product Specifications

Size & Spool Types

Package Details

Sign Out



Product Specifications | Size & Spool Types |

- [Product Specifications](#)
- [Size & Spool Types](#)
- [Package Details](#)
- [Sign Out](#)

SWG Size	AWG Size	Nominal Conductor Diameter	Conductor Tolerance	Conductor Diameter		Nominal Conductor Area	Conductor Weight for 1000m (L)	Conductor Resistance for length at 20°C
				Minimum	Maximum			
		(mm)	(mm)	(mm)	(mm)	(mm ²)	(KG)	(ohm)
11		2.946	0.03	2.916	2.976	6.816	60.598	0.00251
	9	2.906	0.03	2.878	2.921	6.633	58.963	0.0026
12		2.642	0.027	2.615	2.669	5.482	48.737	0.00312
	10	2.588	0.027	2.563	2.601	5.26	46.765	0.0033
13		2.337	0.024	2.313	2.361	4.29	38.134	0.00399
	11	2.304	0.024	2.281	2.316	4.169	37.064	0.0041
	12	2.052	0.021	2.032	2.062	3.307	29.4	0.0052
14		2.032	0.021	2.011	2.053	3.243	28.83	0.00527
15	13	1.829	0.019	1.81	1.848	2.627	23.357	0.00651
16	14	1.626	0.017	1.609	1.643	2.076	18.46	0.00823
	15	1.45	0.017	1.435	1.458	1.615	14.68	0.0104
17		1.422	0.015	1.307	1.437	1.588	14.119	0.0108
	16	1.29	0.015	1.278	1.298	1.307	11.619	0.0132
18		1.219	0.013	1.206	1.232	1.167	10.375	0.0146
	17	1.151	0.013	1.138	1.56	1.0405	9.25	0.0166

Product Specifications | Size & Spool Types |

- [Product Specifications](#)
- [Size & Spool Types](#)
- [Package Details](#)
- [Sign Out](#)

SWG Size	AWG Size	Nominal Conductor Diameter	Conductor Tolerance	Conductor Diameter		Nominal Conductor Area	Conductor Weight for 1000m (L)	Conductor Resistance for length at 20°C
				Minimum	Maximum			
		(mm)	(mm)	(mm)	(mm)	(mm ²)	(KG)	Nominal (ohm)
19	18	1.016	0.011	1.005	1.027	0.811	7.207	0.0211
20	19	0.914	0.01	0.904	0.924	0.6561	5.833	0.0261
21	20	0.813	0.009	0.804	0.822	0.5191	4.615	0.0329
22	21	0.711	0.008	0.703	0.719	0.397	3.53	0.0431
	22	0.643	0.008	0.435	0.645	0.3247	2.87	0.0531
23		0.6	0.006	0.594	0.606	0.2827	2.514	0.0605
24	23	0.559	0.006	0.553	0.565	0.2454	2.182	0.0697
25	24	0.508	0.006	0.502	0.514	0.2027	1.802	0.0843
26	25	0.457	0.005	0.452	0.462	0.164	1.458	0.1042
27	26	0.417	0.005	0.412	0.422	0.1366	1.214	0.1252
28		0.376	0.005	0.379	0.381	0.111	0.987	0.1539
29	27	0.345	0.004	0.341	0.349	0.0935	0.831	0.1829
	28	0.32	0.004	0.318	0.323	0.0804	0.715	0.2144
30		0.315	0.004	0.311	0.319	0.0779	0.693	0.2193
31		0.295	0.004	0.291	0.299	0.0683	0.608	0.2501

Package Details

Cylindrical Type

Parallel Barrel Reels	Wire Range mm	Dimension mm							Reel Capacity kg	Weight of Reel kg
BS1489		D1	D2	D3	D4	D5	L1	L2		
IN 24	0.125-0.250	160	85	36	-	-	125	100	3	0.24
IN 32	0.280-0.800	200	100	38	-	-	155	125	8	0.45
IN 42	0.800-2.240	245	110	40	-	-	150	120	18	0.65

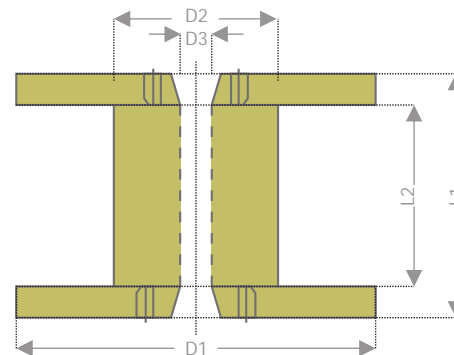

Tapered Type

Product Specifications

Size & Spool Types

Package Details

Sign Out

Package Details

Tapered Type

Parallel Barrel Reels	Wire Range mm	Dimension mm							Reel Capacity kg	Weight of Reel kg
		D1	D2	D3	D4	D5	L1	L2		
DIN 4683 / IEC 264 - 3		D1	D2	D3	D4	D5	L1	L2		
PT - 01	0.125 - 0.150	100	60	16	55	90	120	100	1	0.1
PT - 02	0.170 - 0.212	115	65	20	60	105	170	150	2	0.14
PT - 04	0.190 - 0.250	140	85	25	75	120	200	170	4	0.25
PT - 10	0.100 - 0.315	180	109	30	96	160	230	200	10	0.56
PT - 15	0.100 - 0.315	200	109	30	98	180	230	200	15	0.62
PT - 25	0.500 - 1.120	230	130	33	110	215	280	250	25	1
PT - 90	0.355 - 2.000	315	200	100	180	300	465	425	90	2.2
PT - 100	0.355 - 2.000	315	200	100	180	300	465	425	100	3.9
VR - 45	1.400 - 2.000	250	160	100	140	236	400	335	45	2.22

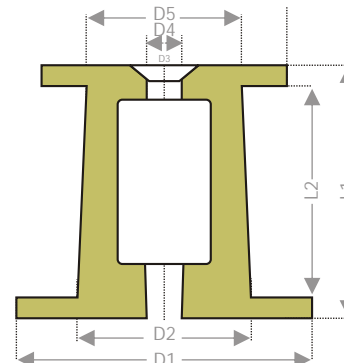

Cylindrical Type

Product Specifications

Size & Spool Types

Package Details

Sign Out

Contact

Product Specifications

Size & Spool Types

Package Details

Sign Out



Salzer Magnet Wires Ltd,
Bettathapuram, Karamadai
Coimbatore - 641 104

T : 04254 302000 F : 04254 2702012

E : smw@salzergroup.com

W : www.salzergroup.com

[Product Specifications](#)

[Size & Spool Types](#)

[Package Details](#)

[Sign Out](#)