

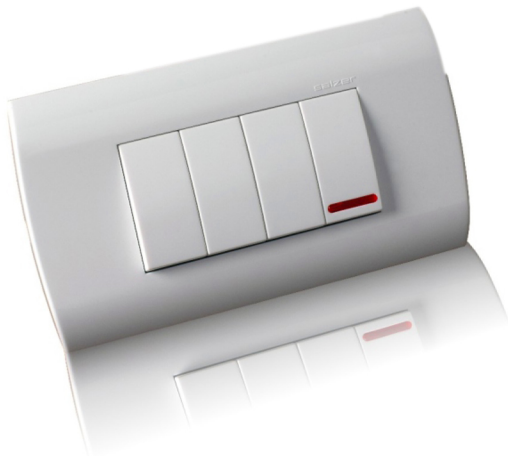

SWITCHES

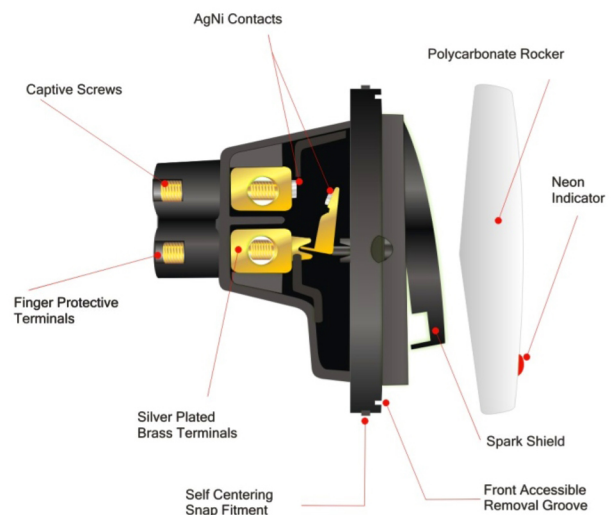

Salzer has a wide range of switches for every kind of Domestic & Work Place application. Each unit is made of High Grade Flame retardant Poly-carboante material incorporated with total safety features such as Finger Protected Terminals & Spark Shield. The AgNi contact design gives smooth operation with Positive making of 'contact' that ensures over 60,000 trouble free operations. Switch range includes 10 & 20 Amp. with and without neon indicators : One Way , Two Way Bell Push & 32 Amp. Double Pole switches.



Manufactured by



its worth a switch
S90 SERIES

SRK Impex

Tel/fax : +91 22 21731008 | Mob : +91 98204 51599, +91 93737 51599 | email : srk@srkimpex.co.in | skype : srk.srkimpex
Address : F8 Niharika Plaza, Gladys Alwares Road, Off Pokhran Road No.2, Thane west - 400610. India



SOCKETS



Salzer collection of Power & Communication Sockets are of high grade poly-carbonate material with gloss finish that with stand extensive wear & tear with hardened Phosphor bronze contacts. Each Socket has a Spring Loaded protective safety shutter. The range includes standard 6Amp - 2 Pin, 5 pins & 6/16 Amps combination sockets. Universal Sockets for all types of plug consideration and a customized IT sockets. Communications sockets for Telephone - 2-Wire/4 Wire configuration, Computer Jacks, TV, Audio & DVD sockets.

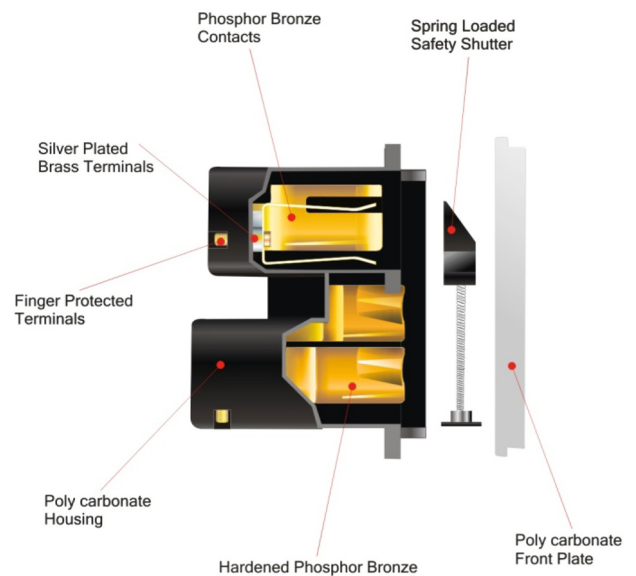

Manufactured by

salzer
WIRES FOR LIFE

its worth a switch
S90 SERIES

SRK Impex

Tel/fax : +91 22 21731008 | Mob : +91 98204 51599, +91 93737 51599 | email : srk@srkimpex.co.in | skype : srk.srkimpex
Address : F8 Niharika Plaza, Gladys Alwares Road, Off Pokhran Road No.2, Thane west - 400610. India

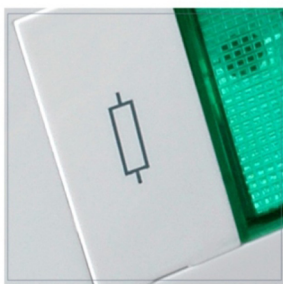
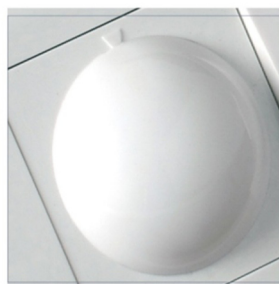

Salzer's range of accessories are customized to make your home or office a show piece of convenience & comfort living. the range includes Capacitive type Humm Free Step Regulators- in One /Two Modules. Light Dimmers 400/1000watts, Night Lights, Buzzers, Bell Indicators Fuse units & Blank Plates

Salzer collection is not only exhaustive but a complete range that can be fitted as Mix & Match configuration The module are true Press & Shut front panel mountings, so easy to install that even you can do it your self.

Manufactured by **salzer**
WIRES FOR LIFE

SRK Impex

Tel/fax : +91 22 21731008 | Mob : +91 98204 51599, +91 93737 51599 | email : srk@srkimpex.co.in | skype : srk.srkimpex
Address : F8 Niharika Plaza, Gladys Alwares Road, Off Pokhran Road No.2, Thane west - 400610. India

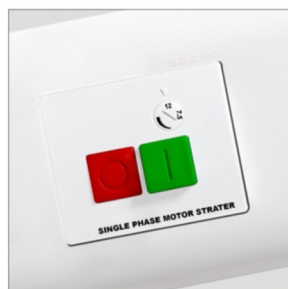

Salzer speciality range of products is unmatched in esthetics and performance. Multi Control Remote Convenience Switch for three light and a fan ideal for living/bedrooms. Sophisticated Movement Sensors for automatic 'switching on/off' corridor/staircase/garage lighting etc., thus saving on electricity bills. Salzer's hospitality range has high tech products such as Dual voltage Shaver Sockets, Key Tag Switches, Dedicated switching console for 'Make My Room' / 'DO Not Disturb'. Programmable Timers for Automatic switching at preset time intervals and dedicated Shock Protectors with a instant tripping of sensitivity 20 mA. Single Phase Motor Starters for the ultimate protection for domestic motors.

Manufactured by **salzer**
WIRES FOR LIFE

SRK Impex

Tel/fax : +91 22 21731008 | Mob : +91 98204 51599, +91 93737 51599 | email : srk@srkimpex.co.in | skype : srk.srkimpex
Address : F8 Niharika Plaza, Gladys Alwares Road, Off Pokhran Road No.2, Thane west - 400610. India

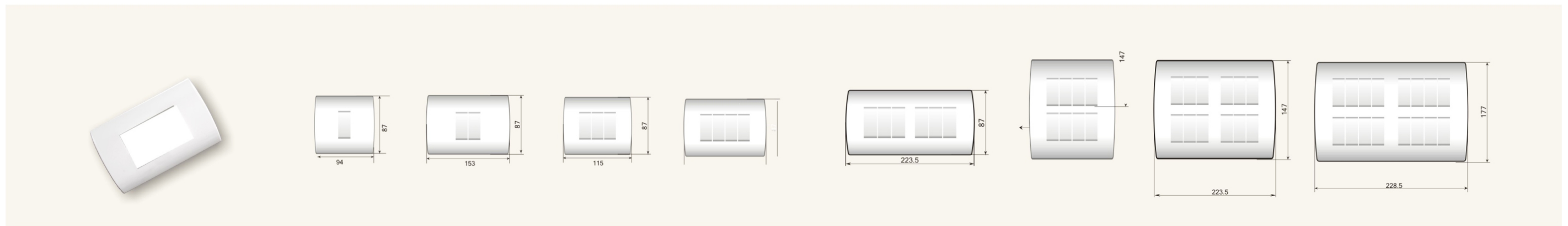
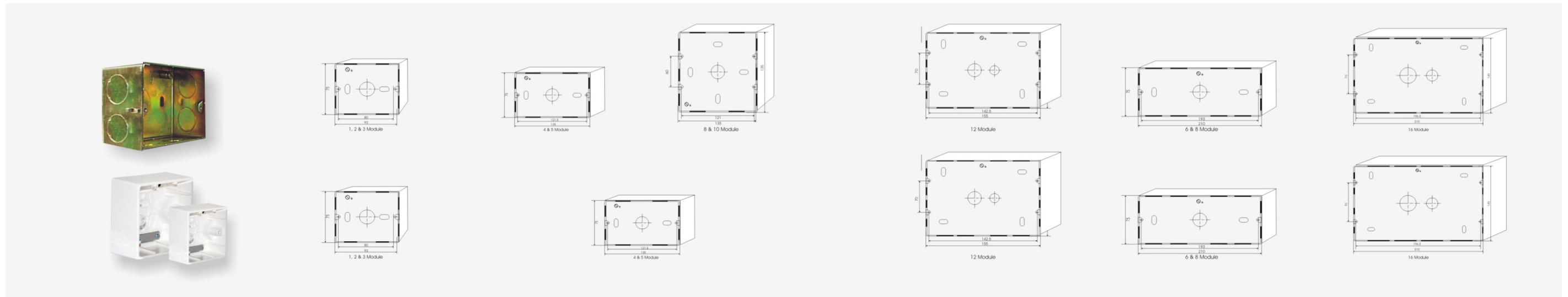
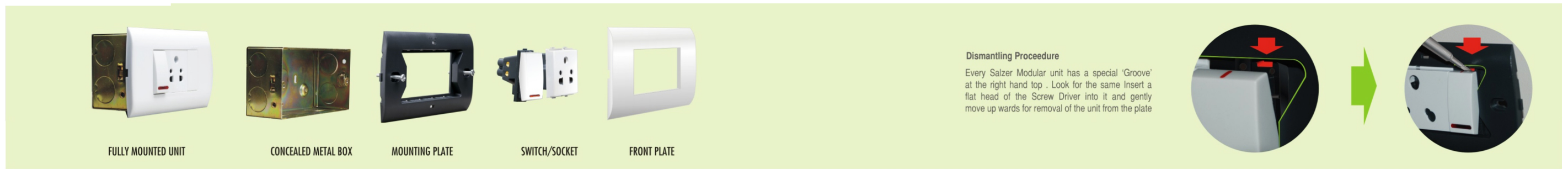

WIRING DIAGRAM

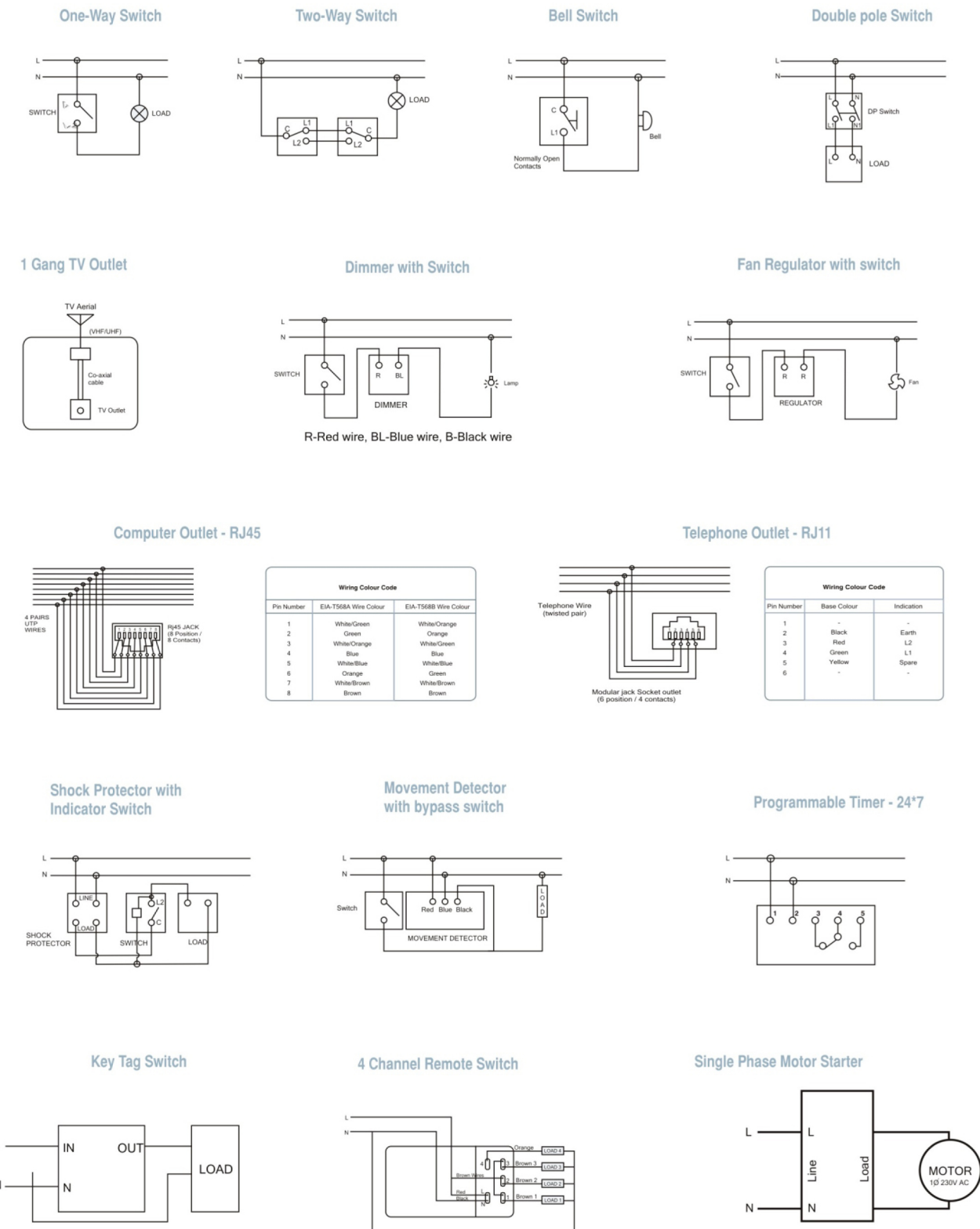

SWITCHES	
AS101	10A 1 Way Switch
AS101L	10A 1 way Switch with indication
AS102	10A 2 Way Switch
AS10B	10A Bell Push Switch
AS10BL	10A Bell Push Switch with Indication
AS10B2L	10A Bell Push Switch with Indication
AS201	20A 1 Way Switch
AS201L	20A 1 Way Switch with Indication
AS202	20A 2 Way Switch
AS32D	32A Double Pole Switch with Indication

POWER SOCKETS	
ASO062	6A 2 Pin Socket
ASO065	6A 5 Pin Socket
ASO16	6/16A Combination Socket
ASO16C	6/16A Combination Socket
ASO13U	13/10/6A Universal Socket for all pins

IT SOCKETS	
ASOIT	IT Socket

REGULATORS & DIMMERS	
AFRG	Step Type Fan Regulator
ADR1	Dimmer
AD400	Dimmer 400W
AD1000	Dimmer 1000W

COMMUNICATION SOCKETS	
ATP2	Telephone Plug
ATS2	Telephone Socket
ATJ2	RJ11-Telephone Jack 2 Wire
ATJ4	RJ11-Telephone Jack 4 Wire
ACOJ	RJ45 Computer Jack
ATVS	TV Socket
ACOJ6	RJ45 Computer Jack - Cat 6
ACO	Cord Outlet
ASOA	Audio Socket
ANIR	Neon Indicator Red
ANIG	Neon Indicator Green
ASOD	DVD Socket

SUPPORT MODULES	
ANL	Night Light
ABZR	Buzzer
ABI	Bell Indicator
AFU06	6/16A Fuse Unit
ABP	Blank Plate
ABP2	Blank Plate

HOTEL / HOSPITALITY RANGE	
AH0	Bell Switch & Indicator
AFL	Foot Light White
SSOW	Shaver Socket
KTSW	Key Tag Switch

PLATES	
AP01	1 Module Plate
AP02	2 Module Plate
AP03	3 Module Plate
AP04	4 Module Plate
AP06	6 Module Plate
AP08	8 Module Plate
AP44	8(V) Module Plate
AP66	12 Module Plate
AP88	16 Module Plate

CONCEALED METAL BOXES	
MB2M	1&2 Module Metal Box
MB3M	3 Module Metal Box
MB5M	4 Module Metal Box
MB8M	6&8 Module Metal Box
MB55M	8(V) Module Metal Box
MB88M	12&16 Module Metal Box

PLASTIC MOULDED SURFACE BOXES	
SB2M	1&2 Module Box
SB3M	3 Module Box
SB4M	4 Module Box
SB6M	6 Module Box
SB8M	8 Module Box

Installation Procedure

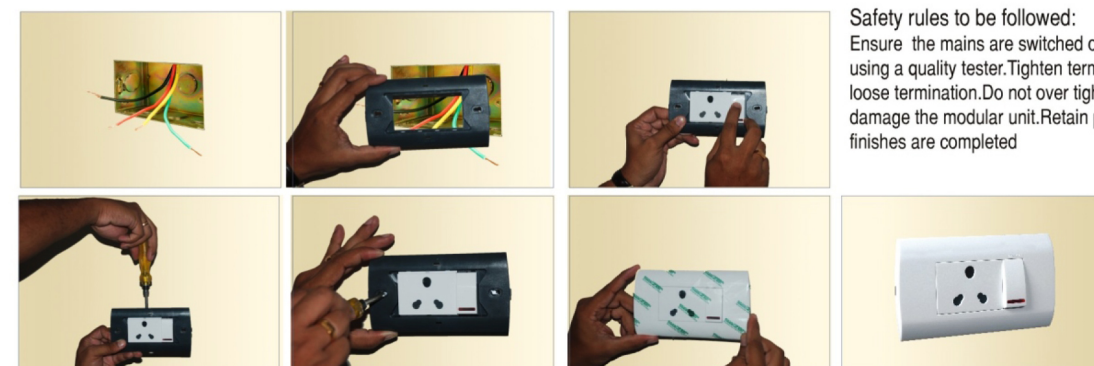

Safety rules to be followed:
 Ensure the mains are switched off. Double check current flow by using a quality tester. Tighten terminal screws properly to avoid loose termination. Do not over tighten the screws as it may damage the modular unit. Retain protective poly cover until wall finishes are completed.