

# GEN NEXT PUSH BUTTON ACTUATOR

- > Unique & Compact design
- > Screw less, quick & easy assembly
- > Stackable design for Contact Blocks
- > Easy identification for NO / NC Blocks
- > Self wiping contacts
- > IP20 finger-safe screw terminals
- > Special fire retardant Plastic Housings to prevent accidental contact with live circuits
- > Electrical life more than 0.5 million & Mechanical life more than 1.0 million
- > International approvals for worldwide use

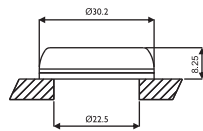

## Flush Head

Cat. No. : EMN□FD1

Colour (4th Digit) : **R** **G** **C** **Y** **W** **B** **A** **F**

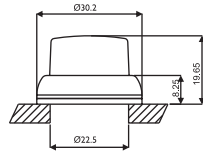

## Projecting Head Push Function

Cat. No. : EMN□PD1

Colour (4th Digit) : **R** **G** **C** **Y** **W** **B** **A** **F**

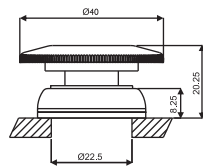

## Mushroom Head Push - Turn Function

Cat. No. : EMN□MH1

Colour (4th Digit) : **R** **G** **C** **Y**

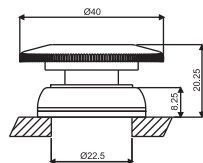

## Mushroom Head Push - Function

Cat. No. : EMN□MD1

Colour (4th Digit) : **R** **G** **C** **Y**

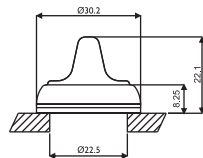

## Symmetric Head

Cat. No. : **2 Position**

Non Spring Return EMN□SK1

Spring Return EMN□S11

### 3 Position

Non Spring Return EMN□SL1

Spring Return EMN□SJ1

Spring Return L.H. EMN□SM1

Spring Return R.H. EMN□SN1

Colour (4th Digit) : **R** **G** **C** **W**

**Note:** 1. Actuators & Selector Actuators with black ABS collar are offered as Standard

2. Actuators (except Mushroom Head Push - Pull Actuators) are also available with chrome plated ABS & Brass collar.

- For Brass Collar replace 7th digit 1 by 2 Eg. EMNPD **2**, For Chrome plated ABS Collar replace 7th digit 1 by 3 Eg. EMNPD **3**

3. For Non-Illuminated Actuator / Selector Actuator at least 1 NO or 1 NC Block required to make a complete Assembly.

eg. EMNRFD1 + EC1C makes complete assembly of flush head actuator with 1 NO Block.

4. Colours available: R - Red, G - Green, C - Black, Y - Yellow, W - White/Opal, B - Blue, A - Amber, F - Gray

# GEN NEXT PUSH BUTTON ACTUATOR & CONTACT BLOCKS

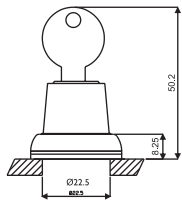

## Lock & Key Rotary Type

Cat. No. : **2 Position**  
 Non Spring Return EMN□KK1  
 Spring Return EMN□KI1  
**3 Position**  
 Non Spring Return EMN□KL1  
 Spring Return EMN□KJ1  
 Spring Return L.H. EMN□KM1  
 Spring Return R.H. EMN□KN1  
 Colour (4th Digit) : C

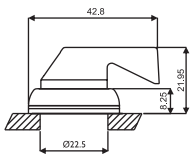

## Lever Head

Cat. No. : **2 Position**  
 Non Spring Return EMN□LK1  
 Spring Return EMN□LI1  
**3 Position**  
 Non Spring Return EMN□LL1  
 Spring Return EMN□LJ1  
 Spring Return L.H. EMN□LM1  
 Spring Return R.H. EMN□LN1  
 Colour (4th Digit) : R C W

**Note:** In 2 position selector actuator, for operating style replace 4th digit from K to R and for operating style replace 4th digit from K to T.

## MODULAR CONTACT BLOCKS



### 'NO' BLOCK

Cat. No. : EC1C



### 'NC' BLOCK

Cat. No. : EC2C

**Note:** Colours available - R - Red, G - Green, C - Black, Y - Yellow, W - White/Opal, B - Blue, A - Amber, F - Gray